

| NEMA Shaft (U) | Keyseat Dimensions (R, S) | | NEMA Shaft (U) | Keyseat Dimensions (R, S) | |
|----------------|---------------------------|------|----------------|---------------------------|-----|
| | (R) | (S) | | (R) | (S) |
| 3/8 | 21/64 | FLAT | 1-7/8 | 1-19/32 | 1/2 |
| 1/2 | 29/64 | FLAT | 2-1/8 | 1-27/32 | 1/2 |
| 5/8 | 33/64 | 3/16 | 2-3/8 | 2-1/64 | 5/8 |
| 7/8 | 49/64 | 3/16 | 2-1/2 | 2-3/16 | 5/8 |
| 1-1/8 | 63/64 | 1/4 | 2-7/8 | 2-29/64 | 3/4 |
| 1-3/8 | 1-13/64 | 5/16 | 3-3/8 | 2-7/8 | 7/8 |
| 1-5/8 | 1-13/32 | 3/8 | 3-7/8 | 3-5/16 | 1 |

Drawings represent standard TEFC general purpose motors.
 *Dimensions are for reference only.

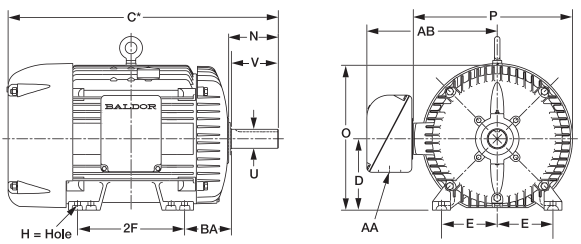

*Contact your local Baldor Sales Office for "C" Dimensions. Dimensions - N, O, P, AB and XO are specific to Baldor.

NEMA QUICK REFERENCE CHART

| NEMA FRAME | D | E | 2F | H | N | O | P | U | V | AA | AB | AH | AJ | AK | BA | BB | BD | XO | TAP | |
|---------------------------------------------------------------------------------|-------|--------|---------|------------|--------|---------|---------|----------|-------|-------|--------|---------|-------|-------|--------|-------|--------|--------|--------|--------|
| 42 | 2-5/8 | 1-3/4 | 1-11/16 | 9/32 SLOT | 1-1/2 | 5 | 4-11/16 | 3/8 | 1-1/8 | 3/8 | 4-1/32 | 1-5/16 | 3-3/4 | 3 | 2-1/16 | 1/8 | 4-5/8 | 1-9/16 | 1/4-20 | |
| 48 | 3 | 2-1/8 | 2-3/4 | 11/32 SLOT | 1-7/8 | 5-7/8 | 5-11/16 | 1/2 | 1-1/2 | 1/2 | 4-3/8 | 1-11/16 | 3-3/4 | 3 | 2-1/2 | 1/8 | 5-5/8 | 2-1/4 | 1/4-20 | |
| 56 56H | 3-1/2 | 2-7/16 | 3 | 11/32 SLOT | 2-7/16 | 6-7/8 | 6-5/8 | 5/8 | 1-7/8 | 1/2 | 5 | 2-1/16 | 5-7/8 | 4-1/2 | 2-3/4 | 1/8 | 6-1/2 | 2-1/4 | 3/8-16 | |
| 143T 145T | 3-1/2 | 2-3/4 | 4 | 5 | 11/32 | 2-1/2 | 6-7/8 | 6-5/8 | 7/8 | 2-1/4 | 3/4 | 5-1/4 | 2-1/8 | 5-7/8 | 4-1/2 | 2-1/4 | 1/8 | 6-1/2 | 2-1/4 | 3/8-16 |
| 182 184 182T 184T | 4-1/2 | 3-3/4 | 4-1/2 | 5-1/2 | 13/32 | 2-11/16 | 8-11/16 | 7-7/8 | 7/8 | 2-1/4 | 3/4 | 5-7/8 | 2-1/8 | 5-7/8 | 4-1/2 | 2-3/4 | 1/8 | 6-1/2 | 2-3/8 | 3/8-16 |
| 213 215 213T 215T | 5-1/4 | 4-1/4 | 5-1/2 | 7 | 13/32 | 3-1/2 | 10-1/4 | 9-9/16 | 1-1/8 | 3 | 1 | 7-3/8 | 2-3/4 | 3-1/8 | 3-1/8 | 1/4 | 9 | 2-3/4 | 1/2-13 | |
| 254U 256U 254T 256T | 6-1/4 | 5 | 8-1/4 | 10 | 17/32 | 4-1/16 | 12-7/8 | 12-15/16 | 1-3/8 | 3-3/4 | 1 | 9-5/8 | 3-1/2 | 3-1/2 | 3-1/2 | 1/4 | 10 | - | 1/2-13 | |
| 284U 286U 284T 286T 284TS 286TS | 7 | 5-1/2 | 9-1/2 | 11 | 17/32 | 5-1/8 | 14-5/8 | 14-5/8 | 1-5/8 | 4-7/8 | 1-1/2 | 13-1/8 | 4-3/8 | 4-3/8 | 4-3/4 | 1/4 | 11-1/4 | - | 1/2-13 | |
| 324U 326U 324T 326T 324TS 326TS | 8 | 6-1/4 | 10-1/2 | 12 | 21/32 | 5-7/8 | 16-1/2 | 16-1/2 | 1-7/8 | 5-5/8 | 2 | 14-1/8 | 5-3/8 | 5-3/8 | 5-1/4 | 1/4 | 13-3/8 | - | 5/8-11 | |
| 364U 366U 364T 366T 364TS 366TS | 9 | 7 | 11-1/4 | 12 | 21/32 | 6-3/4 | 18-1/2 | 19-1/2 | 2-1/8 | 6-3/8 | 3 | 18-1/16 | 6-1/8 | 5-5/8 | 5-7/8 | 1/4 | 13-3/8 | - | 5/8-11 | |
| 404U 405U 404T 405T 404TS 405TS | 10 | 8 | 12-1/4 | 13 | 13/16 | 7-3/16 | 21-5/16 | 22-1/2 | 2-3/8 | 7-1/8 | 3 | 19-1/4 | 6-7/8 | 6-7/8 | 6-5/8 | 1/4 | 13-7/8 | - | 5/8-11 | |
| 444U 445U 444T 445T 447 449T 444TS 445TS 447TS 449TS | 11 | 9 | 14-1/2 | 14 | 13/16 | 8-5/8 | 24.24 | 27.57 | 2-7/8 | 8-5/8 | 3 | 22.68 | 8-3/8 | 8-3/8 | 7-1/2 | 1/4 | 16-3/4 | - | 5/8-11 | |

The above chart provides typical Baldor-Reliance motor dimensions. For more exact dimensional data, please check the specific drawing for each catalog number. NEMA states only a minimum value for AA dimension. AA dimensions shown in chart are Baldor typical values meeting or exceeding NEMA. Please check motor drawing for actual dimensions.

Frame L449T is not included in this chart. Please refer to the Large AC motor chart, or to the specific motor drawings for L449T dimensions.

| NEMA C-Face | BA Dimensions |
|-------------|---------------|
| 143-5TC | 2-3/4 |
| 182-4TC | 3-1/2 |
| 213-5TC | 4-1/4 |
| 254-6TC | 4-3/4 |

BALDOR ELECTRIC COMPANY
 P.O. BOX 2400
 FORT SMITH, ARKANSAS
 72902-2400 U.S.A.

| Frame | NEMA FRAMES PRIOR TO 1953 | | | | | | | |
|-------|---------------------------|---------|-------|--------|-------|-------|-------|--|
| | D | E | F | N | U | V | BA | |
| 68 | 4-1/8 | 2-15/16 | 2-1/2 | 2-1/4 | 3/4 | 2-1/4 | 3-1/8 | |
| 203 | 5 | 4 | 2-3/4 | 2-7/16 | 3/4 | 2 | 3-1/8 | |
| 204 | | | 3-1/4 | | | | | |
| 224 | 5-1/2 | 4-1/2 | 3-3/8 | 3-1/4 | 1 | 3 | 3-1/2 | |
| 225 | | | 3-3/4 | | | | | |
| 254 | 6-1/4 | 5 | 4-1/8 | 3-7/16 | 1-1/8 | 3-3/8 | 4-1/4 | |
| 284 | 7 | 5-1/2 | 4-3/4 | 4-1/4 | 1-1/4 | 3-3/4 | 4-3/4 | |
| 324 | | | 5-1/4 | | | | | |
| 326 | 8 | 6-1/4 | 6 | 5-3/8 | 1-5/8 | 4-7/8 | 5-1/4 | |
| 364 | | | 5-5/8 | | | | | |
| 365 | 9 | 7 | 6-1/8 | 5-5/8 | 1-7/8 | 5-3/8 | 5-7/8 | |
| 404 | | | 6-1/8 | | | | | |
| 405 | 10 | 8 | 6-7/8 | 6-3/8 | 2-1/8 | 6-1/8 | 6-5/8 | |
| 444 | | | 7-1/4 | | | | | |
| 445 | 11 | 9 | 8-1/4 | 7-1/8 | 2-3/8 | 6-7/8 | 7-1/2 | |
| 504 | | | 8 | | | | | |
| 505 | 12-1/2 | 10 | 9 | 8-5/8 | 2-7/8 | 8-3/8 | 8-1/2 | |